

CSD3100 系列

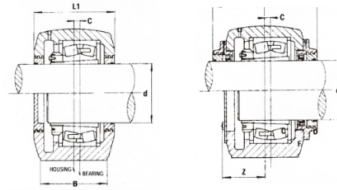
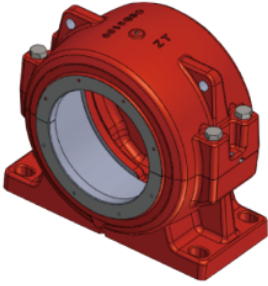

| Lagersitzmodell | Schachtdurchmesser | Abmessungen (mm/in) | | | | | | | | | | | | | | | | 轴承 座量 量 | Lagermodell | Anspannungssatz | Positionierungskreis | |
|-----------------|--------------------|---------------------|------|-----|----|-----|-----|-----|-----|-----|-----|-----|----|----|-----|----|-------|---------------|-------------|-----------------|----------------------|-------|
| | | D | A | B | C | G | H | L1 | L | W | M | N | u | v | S | C | Z | | | | Modell | Menge |
| CSD3168 | 320 | 580 | 830 | 350 | 70 | 210 | 360 | 411 | 527 | 708 | 700 | 240 | 50 | 70 | 153 | 30 | 216.5 | 590 | 23168K | H3168 | SR580x10 | 2 |
| CSD3172 | 340 | 600 | 830 | 350 | 70 | 212 | 360 | 411 | 527 | 708 | 700 | 240 | 50 | 70 | 163 | 30 | 216.5 | 550 | 23172K | H3172 | SR600X10 | 2 |
| CSD3176 | 360 | 620 | 880 | 380 | 75 | 214 | 390 | 431 | 547 | 768 | 760 | 280 | 50 | 70 | 173 | 35 | 226.5 | 740 | 23176K | H3176 | SR620x10 | 2 |
| CSD3180 | 380 | 650 | 880 | 380 | 75 | 220 | 390 | 431 | 547 | 768 | 760 | 280 | 50 | 70 | 183 | 35 | 226.5 | 660 | 23180K | H3160 | SR650x10 | 2 |
| CSD3184 | 400 | 700 | 940 | 400 | 80 | 244 | 440 | 461 | 577 | 853 | 810 | 280 | 50 | 70 | 203 | 35 | 241.5 | 870 | 23184K | H3184 | SR700x10 | 2 |
| CSD3188 | 410 | 720 | 940 | 400 | 0 | 246 | 440 | 461 | 577 | 853 | 810 | 280 | 50 | 70 | 223 | 35 | 241.5 | 810 | 23188K | H3188 | SR720x10 | 2 |
| CSD3192 | 430 | 760 | 1040 | 440 | 80 | 260 | 470 | 501 | 617 | 932 | 880 | 310 | 60 | 80 | 243 | 35 | 261.5 | 1185 | 23192K | H3192 | SR760x10 | 2 |
| CSD3196 | 450 | 790 | 1040 | 440 | 80 | 268 | 470 | 501 | 617 | 932 | 880 | 310 | 60 | 80 | 263 | 35 | 261.5 | 1100 | 23196K | H3196 | SR790x10 | 2 |